

ASBURY
SOLOMONS
Anticipate More





Fall in love

At Asbury Solomons, well-being comes as naturally as friendship, relaxation takes the place of responsibilities you'd rather not tend to, and exploring possibilities to live your best life makes each day an adventure.

Anticipate a life where you move better, feel better, connect more . . . experience more.

On our campus, well-being takes many forms. Kayak by the pier in the morning and stroll the water's edge at dusk. Strengthen and tone in the Well-Being Center and the pool or improve your balance with tai chi or line dancing. Take our brain health classes, join a seminar, or take part in mindful meditation.

And when friends and family come to visit, they'll ask: Can they find a 20-million year-old shark's tooth along the shore? Are Maryland crab cakes the best in the world? Do a million graceful waterfowl overwinter here every year?

Yes! you tell them. It's all true.

It's the rhythm and romance of island life, southern Maryland style. You'll love it.

Make yourself at home

Make choices. That's what it means to be independent. And that's why we give you so many choices.

Dining, for example. Sometimes you'd rather head into town for seafood with the neighbors. Other times, you'd prefer entertaining at home. A sunny afternoon is right for a picnic with a sandwich from the C Store. And watching the sun go down from the Riverview Dining Room is a great way to end any day. Our dining plan is as flexible as you are, and the choices are always yours.

And residential living? Again, your choice. Apartment or cottage? Soaring cathedral ceilings, expansive windows and open floor plan, or something more traditional? Or would you rather choose a waterfront cottage with a cozy screened porch where you can watch the ospreys?

Maintenance is provided, of course, because we know you'd rather spend your time choosing from a wide range of programs, clubs and local offerings that suit your interests.

So go on. We'll take care of the chores, while you make yourself at home.





Content and confident, you're leaving ordinary life behind

The only waterfront CCRC (continuing care retirement community) in southern Maryland, we're truly one-of-a-kind. Set along the Patuxent River near the legendary Chesapeake Bay, we offer an unusually beautiful location that opens an exceptional range of possibilities for retirement living. As a continuing care retirement community, we design programs and create opportunities to strengthen well-being and independence – but offer an on-site continuum of services to meet changing needs.

- Assisted living
- Short-term rehabilitation therapy
- Skilled nursing*
- Home care services

It's a location offering pure contentment and a lifestyle of confidence. And that makes Asbury Solomons like no other retirement community.

**The Asbury Solomons Health Care Center also welcomes seniors from outside our community, regardless of payor source.*

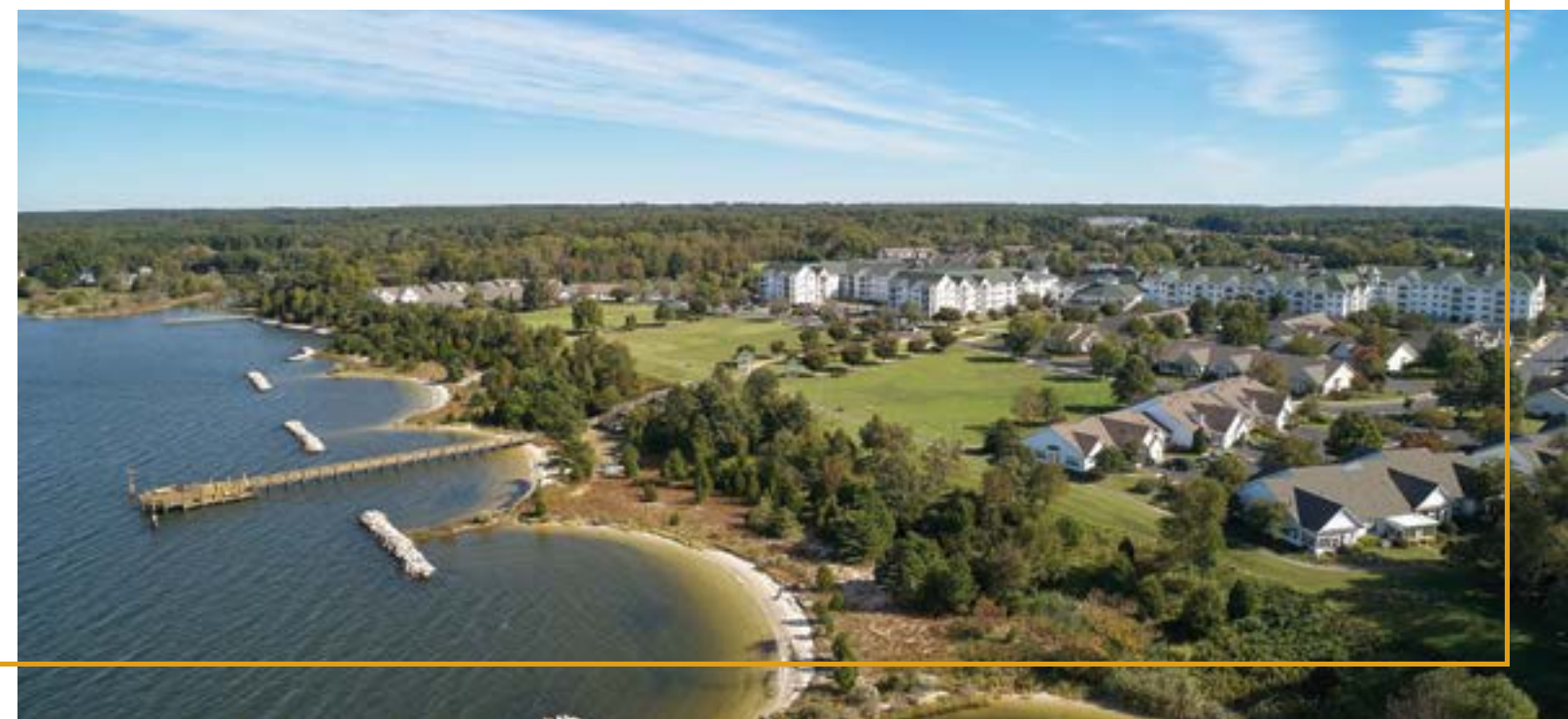



Life gets simpler — and much more rewarding

Without home maintenance headaches, you now have the time to do what you want to do, not what you have to do. Find the pace that suits you, and experience the expansion of opportunities and friendships that come with community living. A growing body of research is demonstrating the importance of social connections and ongoing engagement to our lifelong physical, emotional, and intellectual health.

Hike local destinations with the Hitchhikers, keep your green thumb going in our community garden plots, gather on the Quad for games, grilling, and live music. Invite your friends over for drinks in the Pub and watch the sunset.

In warm months, our waterfront location takes center stage at Asbury Solomons. Enjoy crabbing and fishing from our private wheelchair accessible pier, bird walks along the waterfront, kayaking with the Paddlers or simply dipping your toes in the sand on the warm beach.

A Life Well Lived

Well-being informs everything we do – from classes focusing on flexibility, balance, and strength; to our brain health program and coach; social events and volunteer opportunities; to unique resident clubs, cultural events, and lifelong learning classes; and so much more.

We have more than 50 resident-led clubs like the Go Green Committee, Computer and Art clubs, and The Asbury Solomons Players theater group. And, there is always room for more!

In 2023, Northwestern University and Mather Institute completed their 5-year Age Well Study of more than 8,000 residents of continuing care retirement communities. Overall, residents reported greater emotional, social, physical, and intellectual wellness than their peers, and 70% reported that moving “greatly improved” their social wellness.

Experience award-winning well-being!

In 2023, Asbury Solomons was ranked #1 in the United States for senior wellness by the International Council on Active Aging.



The tradition inspires the future

Asbury Solomons is part of Asbury, a not-for-profit organization managing multiple CCRCs and serving thousands of seniors. Founded in 1926, and rooted in Methodism-founder John Wesley's admonition to "Do all the good you can," the Asbury spirit of service infuses the operation of all its communities — and inspires our way into the future.

Call 410-394-3029 or visit www.AsburySolomons.org for more information.



Glossary | Become familiar with the terminology of senior living.

Accreditation. A seal of approval given by an autonomous organization that demonstrates key indicators they have determined are important to quality, Mission, and strong operations. Asbury holds EAGLE accreditation through the United Methodist Association of Health & Welfare Ministries, which requires rigorous documentation of criteria and a peer review process. Learn more at OurUMA.org/Eagle.

Assisted Living. A special combination of housing, personalized supportive services and health care designed to meet the needs — both scheduled and unscheduled — of those who need help with daily living activities.

CCRC or Continuing Care Retirement Community. A senior living community that provides a written agreement or long-term contract between the resident and the community, providing for a continuum of housing, services and health care, all on one campus or site. Typically, a CCRC includes independent living (or residential living), assisted living and a skilled nursing care center.

Continuum of Care. A reference to the seamlessly integrated levels of care in the progression through independent or residential living to assisted living and skilled nursing.

Entrance Fee. The single, upfront payment that provides for residency in a CCRC.

Independent Living. See Residential Living.

MSF or Monthly Service Fee. Determined by the size of the residence, this fee covers common costs associated with residency, including campus amenities, maintenance, utilities and emergency response.

Not-for-Profit. A status of ownership where governance is through a Board of Trustees. Board members ensure a not-for-profit CCRC's approach to serving seniors meets local needs, maintains financial strength, and aligns with the organization's Mission. Not-for-profit communities turn surplus income back into community improvements and service expansions and operate according to a Mission of service to residents, its key stakeholders.

Residential Living. A healthy, active, engaged lifestyle for independent seniors.

Second-Person Fee. With fee structures built around single occupancy of a residence, two residents can expect a second-person fee to cover the additional costs associated with living here.

Services & Amenities. Lists of what the community provides that enhance the community living experience.

Skilled Nursing. 24-hour care for residents with acute needs. Residents usually rely on assistance for most or all daily living activities. Regular medical supervision and rehabilitation therapies are provided.

Entrance Fee Plans

Asbury Solomons is a mission-focused, not-for-profit Continuing Care Retirement Community. Your one-time entrance fee - paid when you sign a contract for residency at Asbury Solomons - guarantees your residence and access to services for your lifetime. No matter which Entrance Fee Plan you choose, you always have the security of knowing that assisted living, skilled care, and an array of home care services are available to you as part of Asbury's full continuum of care. A complete description of the Entrance Fee Plans can be found in the Residency Agreement.

Choose the Entrance Fee Plan That's Right for You

Based on years of experience, we recognize that people prefer having choices to satisfy different financial objectives. With this in mind, Asbury Solomons offers a variety of contract options:

80% REFUNDABLE PLAN: With this plan, you receive a 80% refund of your entrance fee, payable to you or your estate at the time you are no longer a resident at Asbury Solomons. Again, the advantage of a refundable Entrance Fee Plan is that it allows you to predict the amount of your refund and offers value through preserving your assets for the future.

STANDARD PLAN: Entrance fees for this plan are partially refundable during the first 60 months you live at Asbury Solomons. The refund decreases by 1.667% each month of residency, until after 60 months, there is no refund. Because this plan offers the lowest entrance fees, it is the most affordable way to enjoy the Asbury Solomons lifestyle.

**Generally, the entrance fee is refunded when your residence is re-occupied by a resident who pays a new entrance fee. Specific terms regarding the refund of entrance fees are contained in the Residency Agreement.*

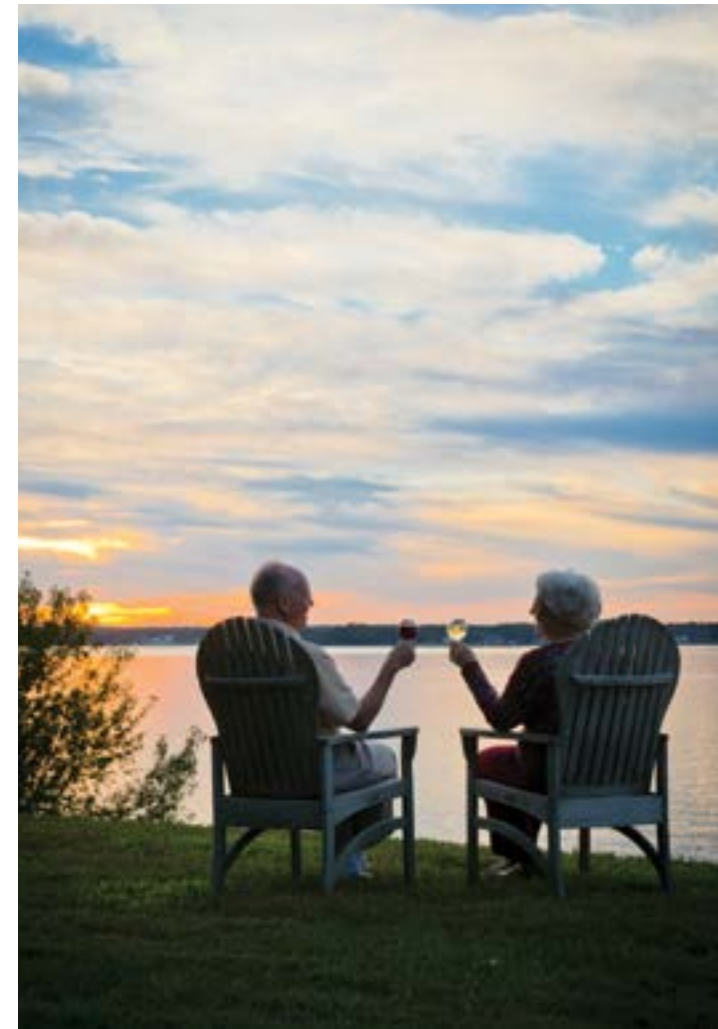

About Asbury: A Legacy of Service

From its founding as a Methodist home for the aged in Gaithersburg, Md., in 1926, we have dedicated ourselves to fostering well-being and expanded possibilities for the thousands of older adults we serve in Maryland, Delaware, and Pennsylvania.

Asbury is a separate legal entity from the United Methodist Church, but we continue to honor our faith-based heritage with a focus on Mission and adherence to our guiding principle of doing all the good we can with integrity, transparency, and grace.

At Asbury, Anticipate More is not just a tagline. It's a promise we've been keeping for close to 100 years.

Commitment to Excellence and Innovation

The Asbury organization is committed to our Mission of exploring possibilities to live our best lives. Our Senior Leadership Team and Board of Directors prioritize smart growth, innovation, and financial strength and stewardship.

We are proud to hold EAGLE Accreditation through the United Methodist Association of Health and Welfare Ministries.



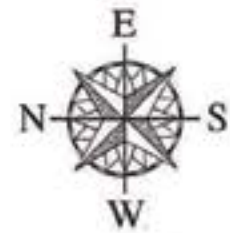
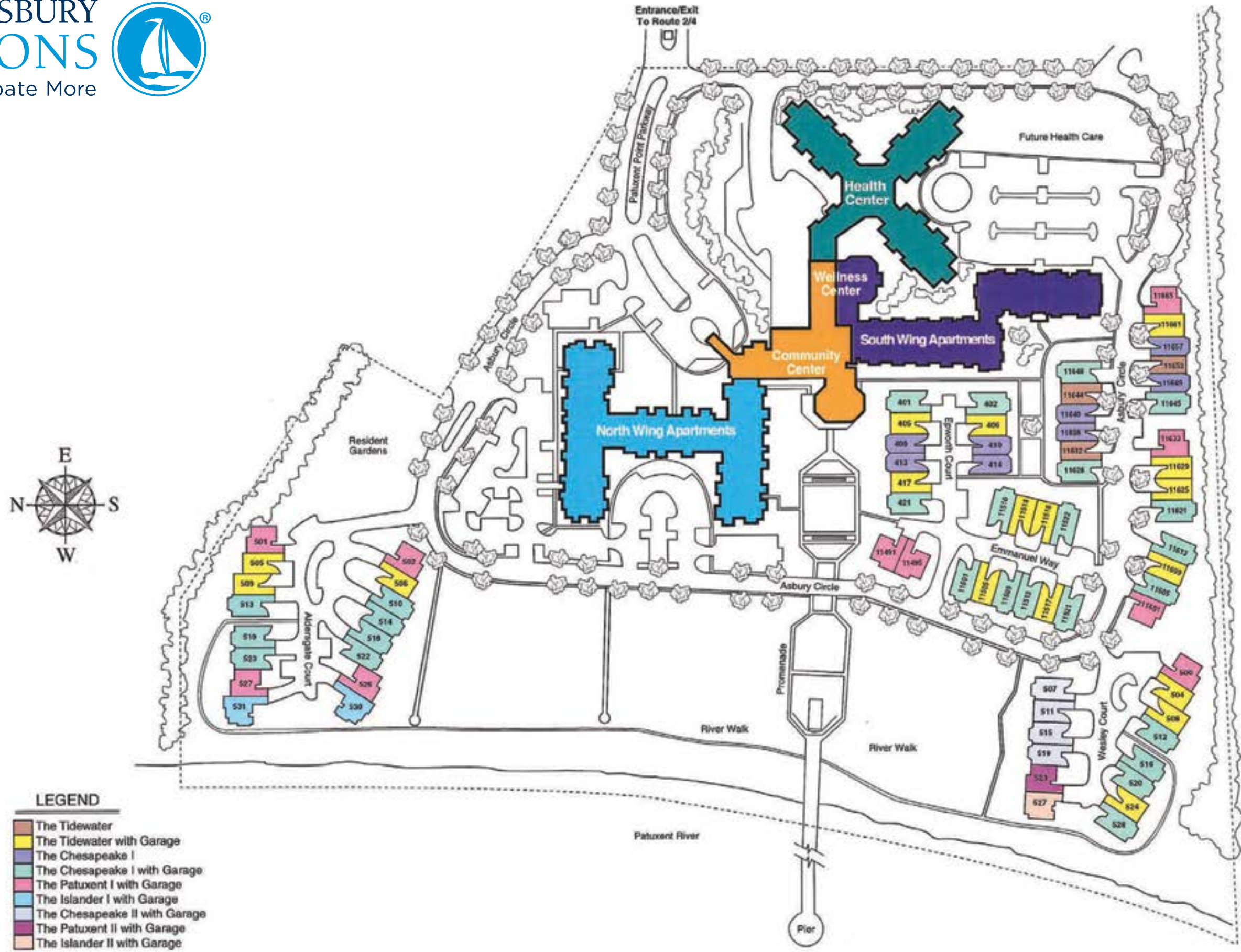

Some recent accomplishments across our system of senior living communities and diversified aging services include:

- Great Place to Work Certification (2023-2017)
- International Council of Active Aging Awards (2023)
 - #1, #8, #17 in Top 25 Senior Communities for Wellness
 - Top 5 Wellness CEOs
- *U.S. News & World Report* Best Nursing Homes (2024, 2023, 2022)
- *Fortune* Top 20 Workplace for Aging Services (2020)
- SAGECare LGBTQ Platinum Accreditation (2019)
- EAGLE Innovation & Best Practice Awards (2018, 2019)





LEGEND

	The Tidewater
	The Tidewater with Garage
	The Chesapeake I
	The Chesapeake I with Garage
	The Patuxent I with Garage
	The Islander I with Garage
	The Chesapeake II with Garage
	The Patuxent II with Garage
	The Islander II with Garage



Services and amenities to enrich the art of everyday living • Waterfront location

ASBURY
SOLOMONS
Anticipate More



11100 Asbury Circle
Solomons, Maryland 20688
AsburySolomons.org
410-394-3029

